

# SUBMITTAL DATA SHEET

JOB NAME: \_\_\_\_\_ DATE: \_\_\_\_\_  
 LOCATION: \_\_\_\_\_  
 ENGINEER: \_\_\_\_\_  
 WHOLESALER: \_\_\_\_\_  
 CONTRACTOR: \_\_\_\_\_  
 SUBMITTED TO: \_\_\_\_\_  
 MODEL DESIGNATION: \_\_\_\_\_ FUEL: \_\_\_\_\_



CHECK ONE: \_\_\_\_\_ REFERENCE (NOT FOR PRODUCTION)  
 \_\_\_\_\_ APPROVED (IMMEDIATE PRODUCTION)  
 \_\_\_\_\_ APPROVED WITH CHANGES NOTED (IMMEDIATE PRODUCTION)

RATINGS AND TECHNICAL DATA							
EVOLUTION EVA Models	INPUT	GROSS	THERMAL	HEATING	WATER	*FUEL	SHIPPING
		OUTPUT	EFFICIENCY	SURFACE	CONTENT	NAT. GAS / LP Gas	WEIGHT
	(MBH)	(MBH)	(%)	(SQ/FT)	(GAL.)	MIN / MAX	(LBS)
<b>EVA-500</b>	500	431	86.2%	123	6.1	5"-14" WC	772
<b>EVA-750</b>	750	638	85.1%	131	15.9	7"-14" WC	1097
<b>EVA-1000</b>	1000	850	85.0%	175	16.4	7"-14" WC	1185
<b>EVA-1500</b>	1500	1275	85.0%	264	17.4	7"-14" WC	1327
<b>EVA-2000</b>	2000	1696	84.8%	352	18.5	7"-14" WC	1461
<b>EVA-2000S</b>	2000	1732	86.6%	411	40.1	4"-14" WC	1835
<b>EVA-2500</b>	2500	2170	86.8%	518	41.6	4"-14" WC	2052
<b>EVA-3000</b>	3000	2610	87.0%	767	43.1	4"-14" WC	2193

\* Please refer to PRODUCT UPDATE issued June 6, 2024. This data supersedes data found on Table 3 of I&O Manual.

## DIMENSIONS

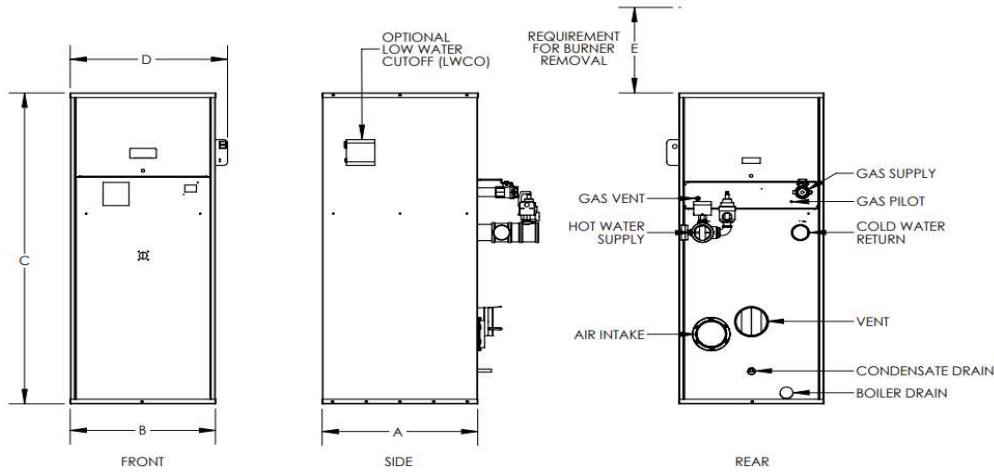

AMP-L MODELS	"A"	"B"	"C"	"D"	"E"	VENT / AIR INTAKE		GAS	SUPPLY	RETURN
	LENGTH	WIDTH	HEIGHT	WIDTH	BURNER REMOVAL	VENT	AIR INTAKE		OUTLET	INLET
	(Inches)	(Inches)	(Inches)	(w/ LWCO)	(Inches)	(Inches)	(Inches)	(Inches)	NPT Male	NPT
<b>EVA-500</b>	30 3/8	28 3/8	71 1/4	31	16	4	4	1	2	2
<b>EVA-750</b>	30 3/8	28 3/8	60 15/16	31	16	4	6	1	3	3
<b>EVA-1000</b>	30 3/8	28 3/8	67 3/8	31	16	6	6	1 1/2	3	3
<b>EVA-1500</b>	30 3/8	28 3/8	79 7/16	31	19	6	8	1 1/2	3	3
<b>EVA-2000</b>	30 3/8	28 3/8	91 7/8	31	31	6	8	1 1/2	3	3
<b>EVA-2000S*</b>	40 1/8	38 1/8	70 1/2	40 3/4	13	6	8	1 1/2	4	4
<b>EVA-2500*</b>	40 1/8	38 1/8	77 1/2	40 3/4	20	8	8	2	4	4
<b>EVA-3000*</b>	40 1/8	38 1/8	84 1/2	40 3/4	16.5	8	8	2	4	4

\* Features Double Row of Copper Fin Tubes!

# SUBMITTAL DATA SHEET

## STANDARD EQUIPMENT

### PRESSURE VESSEL DESIGN

Copper Fin-tube construction  
Carbon steel or cast iron header design  
Gasketless heat exchanger  
ASME Section IV certified "H" stamp  
MAWP 160 PSI & max design temp 250°F  
5-year heat exchanger warranty  
20-year thermal shock warranty

### COMBUSTION DESIGN

Maintenance-free ceramic burner  
Ultr-low NOx emissions (<10ppm)  
Whisper quiet operation (<50 dBA)  
Industrial-grade combustion air filter, 99% efficient  
Industrial cast aluminum blower assembly  
Variable frequency drive  
Electric spark-to-pilot ignition system  
10-year burner warranty  
Robust UV-Scanner

### VENTING

Sealed or room air combustion  
Direct vent (sidewall or vertical) (Cat IV)  
Conventional venting (Cat II)  
**NOTE: This is NOT a Cat 1 Vent appliance.**

### BOILER EQUIPMENT

Siemens RWF55 operating control  
High limit w/ manual reset safety temperature control  
Water flow switch  
Low water cut-off with manual reset safety controller  
Outlet temperature sensor  
Combustion air switch  
Pressure and temperature gauge  
Safety relief valve (optional pressures 30-150 PSI)  
Single point electrical supply (Available in 1 or 3 phase; See below for details).

### BURNER EQUIPMENT

UL/FM/CSD-1 gas train  
Reliable Turndown  
Natural or LP gas  
Pilot gas valve / Pilot gas regulator  
Siemens SKP-75 gas valve  
Low and high gas pressure switches with manual reset

### SIEMENS RWF55 OPERATING CONTROL FEATURES

Adjustable set point  
Remote set point (0-10v or 4-20 mA)  
Outdoor air temperature reset  
Remote system temperature monitoring

## OPTIONAL EQUIPMENT

Low gas pressure venturi, allows operation down to 4" wc (Available on Models 750-2000 Only)

Double block & bleed (DB&B) Gas Train - (1) motorized & (1) solenoid valve & N.O. vent valve

IRI with Proof of Closure Gas Train - (2) motorized valves w/ POC & N.O. vent valve

Honeywell 7800 Series display with ModBus Module

Line Reactor Adds voltage / spike protection for the blower's VFD. (*Highly recommended*.)

Electrical Power Supply:

120/60/1 (*Sizes 500-2000 ONLY*)

208/60/1

230/60/1

208/60/3

230/60/3

460/60/3

Safety Relief Valve Options:

30 PSI

50 PSI

60 PSI

75 PSI

100 PSI

125 PSI

150 PSI

Outdoor Air Sensor

Condensate neutralizer:

850 MBH

1,200 MBH

2,000 MBH

5,000 MBH

Hydronic Kit (Boiler Circulation Pump, Pump Flange Kit and Condensate Neutralizer) Sized based on a 20°F ΔT

Annual Maintenance Kit

Supply system temperature sensor

ModBus communication for Siemens RWF55 and Honeywell Flame Safeguard Control (Boiler to BMS System)

Universal communications gateway (BacNet MS/TP, BacNet/IP, LonWorks)

Local / remote switch

Alarm bell with silencing switch

Relays:

General Alarm

Boiler Status

Conductor Sequencing Panel: (Required for multiple EVA boiler applications without BMS); Contact Regional Manager with Questions.)

The Conductor manages multiple condensing & non-condensing, small & large heat output, new and/or existing boilers (full modulation or on-off), and steam or hot water applications. It helps improve system efficiency by selecting and modulating the right boiler to match operating conditions. The Conductor offers a single point boiler plant Energy Management System (EMS) interface including Modbus TCP/IP, Modbus RTU RS485, BACnet/IP and BACnet MSTP standard. If Lonworks needed, add for the separate Lonworks gateway.

Extended Warranty:

3 Year Parts

5 Year Parts

10-Year Parts

5-Yr. Prts/Lbr

10 Yr. Prts/Lbr